



PRICE LIST

711 Lake Street -- Kent, Ohio 44240
Phone: 330-673-5826 // Toll Free: 800-527-2282

Fax: 330-677-1616

www.frdusa.com

orders@frdusa.com

Fx-a Series

Small Series Hydraulic Breakers

Effective Date: January 01, 2019

Energy Class	Model	Description	List Price \$
150 Ft Lb	Fx15a	Mono-Body Breaker designed for Compact Utility Loaders and select Mini-Excavators • Available in configuration: FB	6,000.00
		Extra standard Working Steel (Moil point or Chisel or Blunt available)	225.00
		Extra Mounting Hardware Set (Pins & Bushings)	395.00
275 Ft Lb	Fx25a	Mono-Body Breaker designed for Compact Utility Loaders and select Mini-Excavators • Available in configuration: FB ME FSP	7,140.00
		Extra standard Working Steel (Moil point or Chisel or Blunt available)	275.00
		Extra Mounting Hardware Set (Pins & Bushings)	395.00
		Dingo Bracket and Mounting Hardware	1,175.00
375 Ft Lb	Fx35a	Mono-Body Breaker designed for Skid-Steer Loaders and Mini-Excavators • Available in configuration: CP FB FSP ME SS WB	8,600.00
	Fx35aQT	Mono-Body Breaker in a "Low Noise" Case with Top Cap for Skid-Steer Loaders & select Mini-Excavators	9,150.00
		Extra standard Working Steel (Moil or Chisel or Blunt)	325.00
		Extra Mounting Hardware Set (Pins & Bushings) – for a Universal Top Cap	525.00
		Additional Top Cap with Mounting for Breaker using FSP or QT configuration	1,675.00
550 Ft Lb	Fx45a	Optional 2-Position Skid-Steer Bracket for ME, FSP, WB or QT configuration (in some instances, extra mtg req)	1,700.00
		Dingo Bracket and Mounting Hardware	1,175.00
550 Ft Lb	Fx45a	Mono-Body Breaker designed for Skid-Steer Loaders, select Mini-Excavators & Backhoes • Available in configuration: CP FB FSP ME SS WB WB50	10,880.00
550 Ft Lb	Fx45aCP-QA	Mono-Body Breaker assembled in a CP027® Brkt & includes a compatible Quick-Attach for Skid-Steer Mtg	12,580.00
550 Ft Lb	Fx45aQT	Mono-Body Breaker in a "Low Noise" Case with Top Cap for Skid-Steer Loaders & select Mini-Excavators	11,650.00
		Extra standard Working Steel (Moil or Chisel or Blunt)	350.00
		Extra Mounting Hardware Set (Pins & Bushings) – for a Universal Top Cap	575.00
		Additional Top Cap with Mounting for Breaker using FSP or QT configuration	1,675.00
		Optional 2-Position Skid-Steer Bracket for ME, FSP, WB or QT configuration (in some instances, extra mtg req)	1,700.00
800 Ft Lb	Fx55a	Mono-Body Breaker designed for Skid-Steer Loaders, select Mini-Excavators & Backhoes • Available in configuration: CP FB FSP ME SS WB WB50	13,250.00
800 Ft Lb	Fx55aCP-QA	Mono-Body Breaker assembled in a CP027® Brkt & includes a compatible Quick-Attach for Skid-Steer Mtg	14,950.00
800 Ft Lb	Fx55aQT	Mono-Body Breaker in a "Low Noise" Case with Top Cap for Skid-Steer Loaders & select Mini-Excavators	14,230.00
		Extra standard Working Steel (Moil or Chisel or Blunt)	450.00
		Extra Mounting Hardware Set (Pins & Bushings) – for a Universal Top Cap	575.00
		Additional Top Cap with Mounting for Breaker using FSP or QT configuration	1,675.00
		Optional 2-Position Skid-Steer Bracket for ME, FSP, WB or QT configuration (in some instances, extra mtg req)	1,700.00

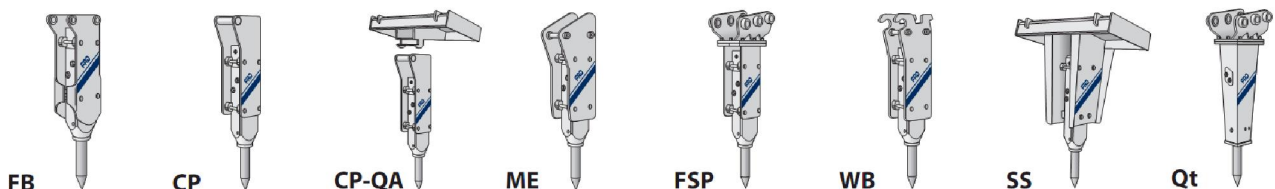

Description of Configurations

FB	Breaker assembled in full length side plates & includes: (2) hose whips, all mounting and (1) standard working steel (moil, chisel, or blunt)
CP	Breaker assembled in full length, 1-piece CP027® bracket & includes: (2) hose whips and (1) standard working steel (moil, chisel, or blunt)
CP-QA	Breaker assembled in full length, 1-piece CP027® bracket & includes: (1) Quick Attach brkt, (2) hose whips and (1) st'd working steel (moil, chisel, or blunt)
ME	Breaker assembled in full length side plates expressly for mini-exc. & includes: (2) hose whips, all mtg, and (1) st'd working steel (moil, chisel, or blunt)
FSP	Breaker assembled in full length, flanged side plates & includes: a top cap, all mounting, (2) hose whips and (1) st'd working steel (moil, chisel, or blunt)
WB	Breaker assembled in full length side plates expressly for Weldco-Beals® coupler & includes: (2) hose whips and (1) st'd working steel (moil, chisel, or blunt)
SS	Breaker assembled in a 1-piece, HD skid-steer quick attach bracket & includes: (2) hose whips and (1) standard working steel (moil, chisel, or blunt)
Qt	Breaker assembled in a full length & protective, low noise case, includes: a top cap, mounting, (2) hose whips & (1) st'd working steel (moil, chisel, or blunt)

POLICY: The policy of FRDUSA is one of continual improvement. We reserve the right to change design or materials at any time, without notice or creating any obligation to previous or future customers.

Prices --- F.O.B. Kent, OH

(All others superseded)

Prices Subject to Change Without Notice



PRICE LIST

711 Lake Street -- Kent, Ohio 44240
Phone: 330-673-5826 // Toll Free: 800-527-2282
Fax: 330-677-1616
www.frdusa.com
orders@frdusa.com

Models F6, F9, Fx125

Medium Series Hydraulic Breakers

Effective Date: January 01, 2019

Energy Class	Model	Description	List Price \$
1,000 Ft Lb	F6	Hydraulic Breaker designed for Skid Steer Loaders, select Mini-Excavators and Backhoes •Available in configuration: FSP ME TLB SS	15,370.00
	F6Qt	Hydraulic Breaker in a "Low Noise" Case with Top Cap for Skid Steer Loaders, select Mini-Exc and Backhoes	16,600.00
		Extra standard Working Steel (Moil point or Chisel or Blunt available)	535.00
		Extra Mounting Hardware Set (Pins & Bushings)	575.00
		Additional Top Cap with Mounting for Breaker using FSP or QT configuration	1,800.00
1,500 Ft Lb	F9	Hydraulic Breaker designed for Skid Steer Loaders, select Mini-Excavators and Backhoes •Available in configuration: FSP TLB	22,760.00
	F9QT	Hydraulic Breaker in a "Low Noise" Case with Top Cap for Skid Steer Loaders, select Mini-Exc and Backhoes	24,450.00
		Extra standard Working Steel (Moil or Chisel or Blunt)	700.00
		Extra Mounting Hardware Set (Pins & Bushings)	575.00
		Additional Top Cap with Mounting for Breaker using FSP or QT configuration	2,275.00
2,000 Ft Lb	Fx125 TLB	Mono-Body Breaker assembled in TLB Side Plates for select Mini-Excavators and Backhoes	26,800.00
	Fx125 Qtv	Mono-Body Breaker assembled in a "Low Noise" Case with Top Cap for select Mini-Excavators	29,900.00
		Extra standard Working Steel (Moil or Chisel or Blunt)	950.00
		Extra Mounting Hardware Set (Pins & Bushings) – for a Universal Top Cap	1,075.00
		Additional Top Cap with Mounting for Breaker using FSP or QT configuration	2,825.00



FSP

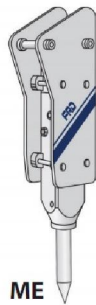

ME

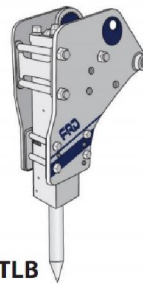

TLB

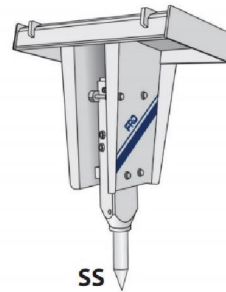

SS



Qt/Qtv

Description of Configurations

FSP	Breaker assembled in full length, flanged side plates & includes: a top cap, all mounting, (2) hose whips and (1) st'd working steel (moil, chisel, or blunt)
ME	Breaker assembled in full length side plates expressly for mini-exc. & includes: (2) hose whips, all mtg, and (1) st'd working steel (moil, chisel, or blunt)
TLB	Breaker assembled in TLB side plates for select Mini Exc and Backhoes & includes: (2) hose whips, all mtg, and (1) st'd working steel (moil, chisel, or blunt)
SS	Breaker assembled in a 1-piece, HD skid-steer quick attach bracket & includes: (2) hose whips and (1) standard working steel (moil, chisel, or blunt)
Qt/Qtv	Breaker assembled in a full length & protective, low noise case, includes: a top cap, mounting, (2) hose whips & (1) st'd working steel (moil, chisel, or blunt)

POLICY: The policy of FRDUSA is one of continual improvement. We reserve the right to change design or materials at any time, without notice or creating any obligation to previous or future customers.

Prices --- F.O.B. Kent, OH

(All others superseded)

Prices Subject to Change Without Notice



PRICE LIST

711 Lake Street -- Kent, Ohio 44240
 Phone: 330-673-5826 // Toll Free: 800-527-2282
 Fax: 330-677-1616
www.frdusa.com
orders@frdusa.com

Fx Series

Large Hydraulic Breakers for 13 to 61 Ton Excavators

Effective Date: January 01, 2019

Energy Class	Model	Description	List Price \$
3,250 Ft Lb	Fx175	Mono-Body Breaker encased in a Qtv Cradle, complete with Top Cap, required Mounting and (1) standard Working Steel (Moil or Chisel or Blunt Style)	38,150.00
		Extra standard Working Steel (Moil point or Chisel or Blunt available)	1,350.00
		Extra Mounting Hardware Set (Pins & Bushings)	1,700.00
		Additional Top Cap (with 13" between centers) with Pins ~ for the Qtv Cradle	3,400.00
4,250 Ft Lb	Fx225	Mono-Body Breaker encased in a Qtv Cradle, complete with Top Cap, required Mounting and (1) standard Working Steel (Moil or Chisel or Blunt Style)	47,500.00
		Extra standard Working Steel (Moil point or Chisel or Blunt available)	1,675.00
		Extra Mounting Hardware Set (Pins & Bushings)	1,700.00
		Additional Top Cap with Pins ~ for the Qtv Cradle	3,950.00
5,250 Ft Lb	Fx275	Mono-Body Breaker encased in a Qtv Cradle, complete with Top Cap, required Mounting and (1) standard Working Steel (Moil or Chisel or Blunt Style)	56,800.00
		Extra standard Working Steel (Moil point or Chisel or Blunt available)	1,850.00
		Extra Mounting Hardware Set (Pins & Bushings)	1,700.00
		Additional Top Cap with Pins ~ for the Qtv Cradle	3,950.00
6,500 Ft Lb	Fx375	Mono-Body Breaker encased in a Qtv Cradle, complete with Top Cap, required Mounting and (1) standard Working Steel (Moil or Chisel or Blunt Style)	73,950.00
		Extra standard Working Steel (Moil point or Chisel or Blunt available)	2,075.00
		Extra Mounting Hardware Set (Pins & Bushings)	1,700.00
		Additional Top Cap with Pins ~ for the Qtv Cradle	4,500.00
8,500 Ft Lb	Fx475	Mono-Body Breaker encased in a Qtv Cradle, complete with Top Cap, required Mounting and (1) standard Working Steel (Moil or Chisel or Blunt Style)	93,050.00
		Extra standard Working Steel (Moil point or Chisel or Blunt available)	2,550.00
		Extra Mounting Hardware Set (Pins & Bushings)	1,700.00
		Additional Top Cap with Pins ~ for the Qtv Cradle	5,100.00

ALL NEW HYDRAULIC BREAKERS ARE SHIPPED COMPLETE WITH TWO (2) WHIP HOSES, BASIC TOOL KIT, PARTS AND OPERATION MANUAL, AND YOUR CHOICE FROM A VARIETY OF STANDARD MOUNTING HARDWARE SETS. ONE (1) STANDARD MOUNTING HARDWARE SET INCLUDED WITH HAMMER. CONTACT FRD.USA FOR PRICING ON CUSTOM MOUNTING AND ANY QUICK ATTACH SYSTEM COMPATIBILITY REQUIREMENTS. PLEASE REFER TO OUR ACCESSORIES PRICE LIST FOR A DETAILED LISTING OF WORKING STEELS AND PRODUCT OPTIONS.

POLICY: The policy of FRDUSA is one of continual improvement. We reserve the right to change design or materials at any time, without notice or creating any obligation to previous or future customers.

Prices --- F.O.B. Kent, OH

(All others superseded)

Prices Subject to Change Without Notice

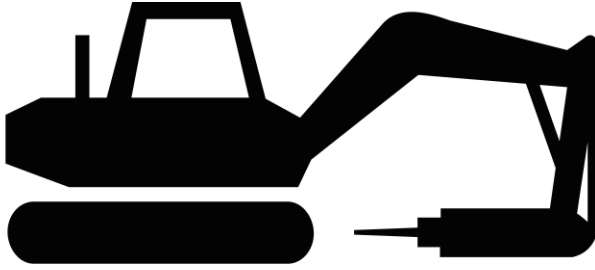

PRICE LIST

711 Lake Street -- Kent, Ohio 44240
 Phone: 330-673-5826 // Toll Free: 800-527-2282
 Fax: 330-677-1616
www.frdusa.com
orders@frdusa.com

F & Fx Series

Extra-Large Hydraulic Breakers for 48.5 to 110 Ton Excavators

Effective Date: January 01, 2019

Energy Class	Model	Description	List Price \$
12,000 Ft Lb	Fx770	Mono-Body Breaker encased in a Qtv Cradle, complete with Top Cap, required Mounting and (1) standard Working Steel (Moil or Chisel or Blunt Style)	126,200.00
		Extra standard Working Steel (Moil point or Chisel or Blunt available)	2,950.00
		Extra Mounting Hardware Set (Pins & Bushings)	2,275.00
		Additional Top Cap with Pins ~ for the Qtv Cradle	5,650.00
15,000 Ft Lb	F100	Mono-Body Breaker encased in a Qtv Cradle, complete with Top Cap, required Mounting and (1) standard Working Steel (Moil or Chisel or Blunt Style)	257,250.00
		Extra standard Working Steel (Moil point or Chisel or Blunt available)	4,700.00
		Extra Mounting Hardware Set (Pins & Bushings)	3,500.00
		Additional Top Cap with Pins ~ for the QT Cradle	9,500.00

ALL NEW HYDRAULIC BREAKERS ARE SHIPPED COMPLETE WITH TWO (2) WHIP HOSES, BASIC TOOL KIT, PARTS AND OPERATION MANUAL, AND YOUR CHOICE FROM A VARIETY OF STANDARD MOUNTING HARDWARE SETS. ONE (1) STANDARD MOUNTING HARDWARE SET INCLUDED WITH HAMMER. CONTACT FRD.USA FOR PRICING ON CUSTOM MOUNTING AND ANY QUICK ATTACH SYSTEM COMPATIBILITY REQUIREMENTS. PLEASE REFER TO OUR ACCESSORIES PRICE LIST FOR A DETAILED LISTING OF WORKING STEELS AND PRODUCT OPTIONS.

POLICY: The policy of FRDUSA is one of continual improvement. We reserve the right to change design or materials at any time, without notice or creating any obligation to previous or future customers.

Prices --- F.O.B. Kent, OH

(All others superseded)

Prices Subject to Change Without Notice

PRICE LIST

711 Lake Street -- Kent, Ohio 44240
 Phone: 330-673-5826 // Toll Free: 800-527-2282
 Fax: 330-677-1616
www.frdusa.com
orders@frdusa.com

Accessories Price List For Small "Fx-a" Series Hammers

Effective: January 1, 2019

Model	Part Number	Description	List Price \$
All Models	KBM21805	Nitrogen Gas Charge Kit	375.00
	K14490	Regulator & Gauge Set	925.00
Fx15a	KF125115	Moil Point, 1.42" Dia. (6 lbs.)	225.00
	KF125114	Chisel Bit, 1.42" Dia. (6 lbs.)	225.00
	KF125111	Blunt Tip, 1.42" Dia. (6 lbs.)	225.00
	(Various)	Mounting Pins & Bushing Set	395.00
Fx25a	KF225115	Moil Point, 1.77" Dia. (11 lbs.)	275.00
	KF225114	Chisel Bit, 1.77" Dia. (11 lbs.)	275.00
	KF225111	Blunt Tip, 1.77" Dia. (11 lbs.)	275.00
	(Various)	Mounting Pins & Bushing Set	395.00
Fx35a	KF325115	Moil Point, 2.0" Dia. (17.5 lbs.)	325.00
	KF325114	Chisel Bit, 2.0" Dia. (17.5 lbs.)	325.00
	KF325111	Blunt Tip, 2.0" Dia. (17.5 lbs.)	325.00
	KF325077	Asphalt Cutter ~ Cross Cut	725.00
	KF330323	Universal Top Cap with Mounting Pins	1,550.00
	(Various)	OEM Top Cap with Mounting Pins	1,550.00
Fx45a	(Various)	Mounting Pins & Bushing Set	575.00
	KF425115	Moil Point, 2.38" Dia. (24 lbs.)	350.00
	KF425114	Chisel Bit, 2.38" Dia. (24 lbs.)	350.00
	KF425111	Blunt Tip, 2.38" Dia. (24 lbs.)	350.00
	KF425049	Asphalt Cutter ~ Cross Cut	945.00
	KF425048	Asphalt Cutter ~ Inline	945.00
	KF425045	Tamper Assembly - 12" square	1,075.00
	KF430500	Universal Top Cap with Mounting Pins	1,550.00
	(Various)	OEM Top Cap with Mounting Pins	1,550.00
	(Various)	Mounting Pins & Bushing Set	575.00
Fx55a	K26666	Two-Position Skid-Steer Bracket	1,700.00
	KBM16500	Auto-Lubrication System Kit (carrier mounted)	1,380.00
	K18410	Pin-on, 1/4 -Yard Wain-Roy® Bracket	1,950.00
	KF525115	Moil Point, 2.68" Dia., 33 lbs.	450.00
	KF525114	Chisel Bit, 2.68" Dia., 33 lbs.	450.00
	KF525111	Blunt Tip, 2.68" Dia., 33 lbs.	450.00
	KF525085	Asphalt Cutter ~ Cross Cut	1,050.00
	KF525084	Asphalt Cutter ~ Inline	1,050.00
	KF525081	Tamper Assembly - 12" square	1,200.00
	KBM630650	Universal Top Cap with Mounting Pins	1,800.00
	(Various)	OEM Top Cap with Mounting Pins	1,675.00
	(Various)	Mounting Pins & Bushing Set	575.00
	K26666	Two-Position Skid-Steer Bracket	1,700.00
	KBM16500	Auto-Lubrication System (carrier mounted)	1,380.00
	K18410	Pin-on, 1/4 -Yard Wain-Roy® Bracket	1,950.00

POLICY: The policy of FRDUSA is one of continual improvement. We reserve the right to change design or materials at any time, without notice or creating any obligation to previous or future customers.

PRICE LIST

711 Lake Street -- Kent, Ohio 44240
 Phone: 330-673-5826 // Toll Free: 800-527-2282
 Fax: 330-677-1616
www.frdusa.com
orders@frdusa.com

Accessories Price List For Medium "F & Fx" Series Hammers

Effective: January 1, 2019

Model	Part Number	Description	List Price \$
All Models	KBM21805	Nitrogen Gas Charge Kit	375.00
	K14490	Regulator & Gauge Set	925.00
F6	KF625113	Moil Point, 3.0" Dia. (47 lbs.)	535.00
	KF625114	Chisel Bit, 3.0" Dia. (47 lbs.)	535.00
	KF625111	Blunt Tip, 3.0" Dia. (47 lbs.)	535.00
	KF625057	Asphalt Cutter ~ <i>Cross Cut</i>	1,160.00
	KF625056	Asphalt Cutter ~ <i>Inline</i>	1,160.00
	KF625053	Tamper Assembly - 12" square	1,295.00
	KBM630650	Universal Top Cap with Mounting Pins	1,800.00
	(Various)	OEM Top Cap with Mounting Pins	1,800.00
	(Various)	Mounting Pins & Bushing Set	575.00
	K26666	Two-Position Skid-Steer Mounting Bracket	1,700.00
	KBM16500	Auto-Lubrication System Kit (carrier mount)	1,380.00
	K18410	Pin-on 1/4 -Yard Wain-Roy® Bracket	1,950.00
F9	KF925113	Moil Point, 3.5" Dia. (78 lbs.)	700.00
	KF925114	Chisel Bit, 3.5" Dia. (78 lbs.)	700.00
	KF925111	Blunt Tip, 3.5" Dia. (78 lbs.)	700.00
	KF925065	Asphalt Cutter ~ <i>Cross Cut</i>	1,265.00
	KF925064	Asphalt Cutter ~ <i>Inline</i>	1,265.00
	KF925061	Tamper Assembly - 12" square	1,380.00
	KBM930950	Universal Top Cap w/Pins	2,275.00
	(Various)	OEM Top Cap with Mounting Pins	2,275.00
	(Various)	Mounting Pins & Bushing Set	575.00
	K26666	Two-Position Skid-Steer Bracket	1,700.00
	KBM22218	Underwater Kit	155.00
	KBM16500	Auto-Lubrication System (Carrier mounted)	1,380.00
	K18410	Pin-on, 1/4 -Yard Wain-Roy® Bracket	1,950.00
Fx125	KFX12525225	Moil Point, 4.33" Dia. (145 lbs.)	950.00
	KFX12525224	Chisel Bit, 4.33" Dia. (145 lbs.)	950.00
	KFX12525221	Blunt Tip, 4.33" Dia. (145 lbs.)	950.00
	KF12050	Universal Top Cap with Mounting Pins	2,825.00
	(Various)	OEM Top Cap with Mounting Pins	2,825.00
	(Various)	Mounting Pins & Bushing Set	1,075.00
	KBM22221	Underwater Kit	205.00
	KBM16501	Auto-Lubrication System Kit (Carrier mounted)	1,825.00
	KBM16561	One-Shot Lubrication System Kit (Hammer mounted)	2,500.00
	KBM16825	Shaker Lubrication System Kit (Hammer mounted)	2,500.00

POLICY: The policy of FRDUSA is one of continual improvement. We reserve the right to change design or materials at any time, without notice or creating any obligation to previous or future customers.

PRICE LIST

711 Lake Street -- Kent, Ohio 44240
 Phone: 330-673-5826 // Toll Free: 800-527-2282
 Fax: 330-677-1616
www.frdusa.com
orders@frdusa.com

Accessories Price List page 1 of 2 For Large "Fx" Series Hammers

Effective: January 1, 2019

Model	Part Number	Description	List Price \$
All Models	KBM21805	Nitrogen Gas Charge Kit	375.00
	K14490	Regulator & Gauge Set	925.00
Fx175	KFX17525225	Moil Point, 4.72" Dia. (220 lbs.)	1,350.00
	KFX17525224	Chisel Bit, 4.72" Dia. (220 lbs.)	1,350.00
	KFX17525221	Blunt Tip, 4.72" Dia. (220 lbs.)	1,350.00
	KF12050	Universal Top Cap (max stick width of 13") w/ Mounting Pins	3,400.00
	KFX175050	Universal Top Cap (13" to 15" stick width) w/ Mounting Pins	3,400.00
	(Various)	OEM Top Cap with Mounting Pins	3,400.00
	(Various)	Mounting Pins & Bushing Set	1,700.00
	KBM22220-FX	Underwater Kit	205.00
	KBM16501	Auto-Lubrication System Kit (carrier mounted)	1,825.00
	KBM16556	One-Shot Lubrication System Kit (Hammer mounted)	3,090.00
	KBM16558	Continuous Lubrication System Kit (Hammer mounted)	3,090.00
	KBM16826	Shaker Lubrication System Kit (Hammer mounted)	2,500.00
Fx225	KFX22525225	Moil Point, 5.25" Dia. (280 lbs.)	1,675.00
	KFX22525224	Chisel Bit, 5.25" Dia. (280 lbs.)	1,675.00
	KFX22525221	Blunt Tip, 5.25" Dia. (280 lbs.)	1,675.00
	KF22050	Universal Top Cap with Mounting Pins	3,950.00
	(Various)	OEM Top Cap with Mounting Pins	3,950.00
	(Various)	Mounting Pins & Bushing Set	1,700.00
	KBM22220-FX	Underwater Kit	205.00
	KBM16501	Auto-Lubrication System Kit (carrier mounted)	1,825.00
	KBM16557	Continuous Lubrication System Kit (Hammer mounted)	3,090.00
	KBM16827	Shaker Lubrication System Kit (Hammer mounted)	2,500.00
Fx275	KFX27525225	Moil Point, 5.51" Dia. (320 lbs.)	1,850.00
	KFX27525224	Chisel Bit, 5.51" Dia. (320 lbs.)	1,850.00
	KFX27525221	Blunt Tip, 5.51" Dia. (320 lbs.)	1,850.00
	KF22050	Universal Top Cap with Mounting Pins	3,950.00
	(Various)	OEM Top Cap with Mounting Pins	3,950.00
	(Various)	Mounting Pins & Bushing Set	1,700.00
	KBM22220-FX	Underwater Kit	205.00
	KBM16501	Auto-Lubrication System Kit (carrier mounted)	1,825.00
	KBM16536D	One-Shot Lubrication System Kit (Hammer mounted)	3,090.00
	KBM16557	Continuous Lubrication System Kit (Hammer mounted)	3,090.00
	KBM16826	Shaker Lubrication System Kit (Hammer mounted)	2,500.00

POLICY: The policy of FRDUSA is one of continual improvement. We reserve the right to change design or materials at any time, without notice or creating any obligation to previous or future customers.

PRICE LIST

711 Lake Street -- Kent, Ohio 44240
 Phone: 330-673-5826 // Toll Free: 800-527-2282
 Fax: 330-677-1616
www.frdusa.com
orders@frdusa.com

Accessories Price List page 2 of 2 For Large "Fx" Series Hammers

Effective: January 1, 2019

Model	Part Number	Description	List Price \$
All Models	KBM21805	Nitrogen Gas Charge Kit	375.00
	K14490	Regulator & Gauge Set	925.00
Fx375	KFX37525225	Moil Point, 6.10" Dia. (330 lbs.)	2,075.00
	KFX37525224	Chisel Bit, 6.10" Dia. (330 lbs.)	2,075.00
	KFX37525221	Blunt Tip, 6.10" Dia. (330 lbs.)	2,075.00
	KF35050	Universal Top Cap w/ Mounting Pins; 475mm (18.7") Centers	4,500.00
	KF35051	Universal Top Cap w/ Mounting Pins; 572mm (22.52") Centers	4,500.00
	(Various)	OEM Top Cap with Mounting Pins	4,500.00
	(Various)	Mounting Pins & Bushing Set	1,700.00
	KBM22220-FX	Underwater Kit	205.00
	KBM16502	Auto-Lubrication System Kit (Carrier mounted)	2,215.00
	TBA	One-Shot Lubrication System Kit (Hammer mounted)	TBA
	KBM16558	Continuous Lubrication System Kit (Hammer mounted)	3,090.00
	KBM16810	Shaker Lubrication System Kit (Hammer mounted)	2,500.00
Fx475	KFX47525225	Moil Point, 6.5" Dia., 475 lbs.	2,550.00
	KFX47525224	Chisel Bit, 6.5" Dia., 475 lbs.	2,550.00
	KFX47525221	Blunt Tip, 6.5" Dia., 475 lbs.	2,550.00
	KF45050	Universal Top Cap w/ Mounting Pins; (21.14") 537mm Centers	5,100.00
	KF45051	Universal Top Cap w/ Mounting Pins; 572mm (22.52") Centers	5,100.00
	(Various)	OEM Top Cap with Mounting Pins	5,100.00
	(Various)	Mounting Pins & Bushing Set	1,700.00
	KBM22220-FX	Underwater Kit	205.00
	KBM16502	Auto-Lubrication System (Carrier mounted)	2,215.00
	TBA	One-Shot Lubrication System Kit (Hammer mounted)	TBA
	KBM16559	Continuous Lubrication System Kit (Hammer mounted)	3,090.00
	KBM16810	Shaker Lubrication System Kit (Hammer mounted)	2,500.00

POLICY: The policy of FRDUSA is one of continual improvement. We reserve the right to change design or materials at any time, without notice or creating any obligation to previous or future customers.

PRICE LIST

711 Lake Street -- Kent, Ohio 44240
 Phone: 330-673-5826 // Toll Free: 800-527-2282
 Fax: 330-677-1616
www.frdusa.com
orders@frdusa.com

Accessories Price List For Extra Lg "F & Fx" Series Hammers

Effective: January 1, 2019

Model	Part Number	Description	List Price \$
All Models	KBM21805	Nitrogen Gas Charge Kit	375.00
	K14490	Regulator & Gauge Set	925.00
Fx770	KFX77025225	Moil Point, (<i>diameter & weight of point TBA</i>)	2,950.00
	KFX77025224	Chisel Bit, (<i>diameter & weight of point TBA</i>)	2,950.00
	KFX77025221	Blunt Tip, (<i>diameter & weight of point TBA</i>)	2,950.00
	KF70050	Universal Top Cap with Mounting Pins	5,650.00
	TBA	"Wide Stick" Universal Top Cap with Mounting Pins	5,650.00
	(Various)	OEM Top Cap with Mounting Pins	5,650.00
	(Various)	Mounting Pins & Bushing Set	2,275.00
	TBA	Underwater Kit	TBA
	KBM16560	Auto-Lubrication System Kit (carrier mounted)	3,675.00
	TBA	'One-Shot' Lubrication System Kit (Hammer mounted)	TBA
	KBM16626	Continuous Lubrication System Kit (Hammer mounted)	3,735.00
	KBM16812	Shaker Lubrication System Kit (Hammer mounted)	2,500.00
F100	K14306	Moil Point, 8.27" Dia. (1,050 lbs.)	4,700.00
	K14307	Chisel Bit, 8.27" Dia. (1,050 lbs.)	4,700.00
	K14305	Blunt Tip, 8.27" Dia. (1,050 lbs.)	4,700.00
	KF10050	Universal Top Cap with Mounting Pins	9,500.00
	(Various)	Mounting Pins & Bushing Set	3,500.00
	KBM22220-F100	Underwater Kit	205.00
	KBM16560	Auto-Lubrication System (carrier mounted) (x2)	4,430.00
	TBA	Continuous Lubrication System Kit (Hammer mounted) (x2)	TBA

POLICY: The policy of FRDUSA is one of continual improvement. We reserve the right to change design or materials at any time, without notice or creating any obligation to previous or future customers.



PRICE LIST

711 Lake Street -- Kent, Ohio 44240
Phone: 330-673-5826 // Toll Free: 800-527-2282
Fax: 330-677-1616
www.frdusa.com
orders@frdusa.com

Effective Date: January 01, 2019

HydraPak; Vibratory Plate Soil Compactors

Impulse Force	Model	Description	List Price \$
3,000 lbs.	HP35ME	12" wide Vibratory Plate Soil Compactor / Sheeting Driver; Direct Pin-on Style <i>Available with Hanger Bracket: UNV</i>	5,095.00
	HP35ME-S_	12" wide Vibratory Plate Soil Compactor / Sheeting Driver; for specific Mounting <i>Available with Hanger Bracket: TLB BOB KU80 WR CP WB WB50 OEM</i>	5,490.00
	HP35ME-S	12" wide Vibratory Plate Soil Compactor / Sheeting Driver; with Flat Top Hanger Bracket & Specific Top Cap <i>Available with Hanger Bracket: FT</i>	6,380.00
6,500 lbs.	HP65II 18TLB	18" wide Vibratory Plate Soil Compactor / Sheeting Driver; Direct Pin-on Style <i>Available with Hanger Bracket: TLB</i>	6,080.00
	HP65II 18_	18" wide Vibratory Plate Soil Compactor / Sheeting Driver; for specific Mounting <i>Available with Hanger Bracket: FB WR</i>	6,545.00
	HP65II 18FT	18" wide Vibratory Plate Soil Compactor / Sheeting Driver; with Flat Top Hanger Bracket & Specific Top Cap <i>Available with Hanger Bracket: FT</i>	6,940.00
	HP65II TLB	24" wide Vibratory Plate Soil Compactor / Sheeting Driver; Direct Pin-on Style <i>Available with Hanger Bracket: TLB</i>	6,080.00
	HP65II _	24" wide Vibratory Plate Soil Compactor / Sheeting Driver; for specific Mounting <i>Available with Hanger Bracket: FB WR</i>	6,545.00
	HP65II FT	24" wide Vibratory Plate Soil Compactor / Sheeting Driver; with Flat Top Hanger Bracket & Specific Top Cap <i>Available with Hanger Bracket: FT</i>	6,940.00
7,800 lbs.	HP75 TLB	24" wide Vibratory Plate Soil Compactor / Sheeting Driver; Direct Pin-on Style <i>Available with Hanger Bracket: TLB</i>	6,345.00
	HP75 _	24" wide Vibratory Plate Soil Compactor / Sheeting Driver; for specific Mounting <i>Available with Hanger Bracket: FB WR</i>	6,890.00
	HP75 FT	24" wide Vibratory Plate Soil Compactor / Sheeting Driver; with Flat Top Hanger Bracket & Specific Top Cap <i>Available with Hanger Bracket: FT</i>	7,275.00

Carrier Hanger Bracket
Options for the
HP35



Carrier Hanger Bracket
Options for the
HP65 & HP75



Description of
Configurations

UNV	Universal mount, direct pin-on for mini-excavators not utilizing a quick coupler
TLB	For direct pin-on for backhoe mounting
BOB	For carriers utilizing the Bobcat Exchange System®
FT	To accommodate carriers requiring specific OEM mounting by utilizing a specific top cap
KU80	For carriers utilizing the Kubota 7880® coupler
WR	For carriers utilizing the Wain-Roy® mounting system
CP	For carriers utilizing the CP-027® mounting system
WB	For carriers utilizing the Weldco-Beales 27/35 coupler®
WB50	For carriers utilizing the Weldco-Beales 50 coupler®
OEM	For carriers utilizing OEM pin spacing
FB	A "Floating-Boss" mounting system for carriers requiring OEM pin centers

Note: HydraPaks are supplied with all necessary Mounting Pins and Bushings (when applicable)

POLICY: The policy of FRDUSA is one of continual improvement. We reserve the right to change design or materials at any time, without notice or creating any obligation to previous or future customers.

Prices --- F.O.B. Kent, OH

(All others superseded)

Prices Subject to Change Without Notice



PRICE LIST

711 Lake Street -- Kent, Ohio 44240
Phone: 330-673-5826 // Toll Free: 800-527-2282
Fax: 330-677-1616
www.frdusa.com
orders@frdusa.com

HydraPak; Vibratory Plate Soil Compactors

Effective Date: January 01, 2019

Impulse Force	Model	Description	List Price \$
13,500 lbs.	HP135II	28" wide Vibratory Plate Soil Compactor / Sheeting Driver; Direct Pin-on Style	9,850.00
		Available with Hanger Bracket: UNV	
		Additional mounting sets to accommodate alternative mountings	1,700.00
	HP135II _	28" wide Vibratory Plate Soil Compactor / Sheeting Driver; for specific Mounting	10,740.00
		Available with Hanger Bracket: FT FB	
		Additional mounting sets to accommodate alternative mountings	1,700.00
		Additional top cap to accommodate alternative mountings	3,400.00
21,000 lbs.	HP210II	28" wide Vibratory Plate Soil Compactor / Sheeting Driver; Direct Pin-on Style	14,320.00
		Available with Hanger Bracket: UNV	
		Additional mounting sets to accommodate alternative mountings	1,700.00
	HP210II _	28" wide Vibratory Plate Soil Compactor / Sheeting Driver; for specific Mounting	15,220.00
		Available with Hanger Bracket: FT FB	
		Additional mounting sets to accommodate alternative mountings	1,700.00
		Additional top cap to accommodate alternative mountings	3,950.00



UNV



FT



FB

Description of Configurations

UNV	Universal mount, direct pin-on for mini-excavators not utilizing a quick coupler
FB	A "Floating-Boss" mounting system for carriers requiring OEM pin centers
FT	To accommodate carriers requiring specific OEM mounting by utilizing a specific top cap

Note: HydraPaks are supplied with all necessary Mounting Pins and Bushings (when applicable)

POLICY: The policy of FRDUSA is one of continual improvement. We reserve the right to change design or materials at any time, without notice or creating any obligation to previous or future customers.

PRICE LIST

711 Lake Street -- Kent, Ohio 44240
 Phone: 330-673-5826 // Toll Free: 800-527-2282
 Fax: 330-677-1616
www.frdusa.com
orders@frdusa.com

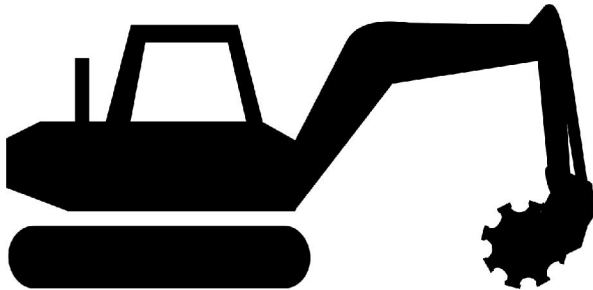

Boom Mounted Static Wheel Compactors for Mini-Excavators and Excavators

Effective: January 1, 2019

Model	Description	Price
CW 18III	Static Compaction Wheel, 18" Wide, Rectangular Padfoot, Pin-on Mounting	\$7,500.00
	Extra Mounting Hardware Set (Pins and Bushings) for standard compactor	575.00
CW 18IV WR	Static Compaction Wheel, 18" Wide, Rectangular Padfoot, Wainroy® mounting	\$7,000.00
CW 24III	Static Compaction Wheel, 24" Wide, Rectangular Padfoot, Pin-on Mounting	\$10,500.00
	Extra Mounting Hardware Set (Pins and Bushings) for standard compactor	1,075.00
CW 36III	Static Compaction Wheel, 36" Wide, Rectangular Padfoot, Pin-on Mounting	\$13,500.00
	Extra Mounting Hardware Set (Pins and Bushings) for standard compactor	1,700.00

POLICY: The policy of FRDUSA is one of continual improvement. We reserve the right to change design or materials at any time, without notice or creating any obligation to previous or future customers.
 Contact FRD.USA for Pricing on Custom mounting, any Quick Attach System and Compatibility Requirements

PRICE LIST

711 Lake Street -- Kent, Ohio 44240
 Phone: 330-673-5826 // Toll Free: 800-527-2282
 Fax: 330-677-1616
 www.frdusa.com
 orders@frdusa.com



TEFRA Auto-Couplers for Mini-Excavators, Backhoes, and Excavators

Effective: January 1, 2019

Model	Description	Price
TAC 30	TEFRA Auto-Coupler for 3 Ton Class Carrier Installation Kit for TEFRA Coupler	\$3,275.00 <u>\$1,675.00</u> \$4,950.00
TAC 50	TEFRA Auto-Coupler for 5 Ton Class Carrier Installation Kit for TEFRA Coupler	\$3,550.00 <u>\$1,675.00</u> \$5,225.00
TAC 70	TEFRA Auto-Coupler for 7 to 8 Ton Class Carrier Installation Kit for TEFRA Coupler	\$3,905.00 <u>\$1,675.00</u> \$5,580.00
TAC 130	TEFRA Auto-Coupler for 13 Ton Class Carrier Installation Kit for TEFRA Coupler	\$5,750.00 <u>\$1,675.00</u> \$7,425.00
TAC 160	TEFRA Auto-Coupler for 16 Ton Class Carrier Installation Kit for TEFRA Coupler	\$6,450.00 <u>\$1,675.00</u> \$8,125.00
TAC 210	TEFRA Auto-Coupler for 21 Ton Class Carrier Installation Kit for TEFRA Coupler	\$7,295.00 <u>\$1,675.00</u> \$8,970.00
TAC 260	TEFRA Auto-Coupler for 25 Ton Class Carrier Installation Kit for TEFRA Coupler	\$8,375.00 <u>\$1,675.00</u> \$10,050.00
TAC 325	TEFRA Auto-Coupler for 30 Ton Class Carrier Installation Kit for TEFRA Coupler	\$8,950.00 <u>\$1,675.00</u> \$10,625.00
TAC 350	TEFRA Auto-Coupler for 35 Ton Class Carrier Installation Kit for TEFRA Coupler	\$9,850.00 <u>\$1,675.00</u> \$11,525.00
TAC 450	TEFRA Auto-Coupler for 45 Ton Class Carrier Installation Kit for TEFRA Coupler	\$10,275.00 <u>\$1,675.00</u> \$11,950.00

Contact FRD.USA for specific system and carrier compatibility or for other special requirements.
 FRD.USA TEFRA Coupler Installation Kits are specifically designed and are required for safe and correct operation.

POLICY: The policy of FRDUSA is one of continual improvement. We reserve the right to change design or materials at any time, without notice or creating any obligation to previous or future customers.

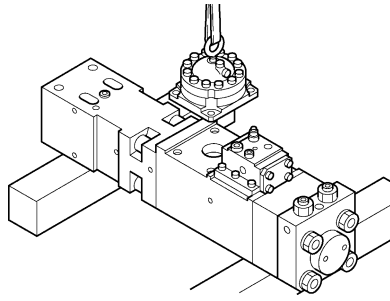

PRICE LIST

711 Lake Street -- Kent, Ohio 44240
 Phone: 330-673-5826 // Toll Free: 800-527-2282
 Fax: 330-677-1616
www.frdusa.com
orders@frdusa.com

Encore Recertification Program

Effective: March 1, 2019

Series	Hydraulic Breaker Model Size F Series/FX Series		Tier I Net Price F Series/FX Series	Tier II Net Price F Series/FX Series	Tier III Net Price F Series/FX Series
Small	F 1/Fx 15		\$365	\$1,155/\$1,075	\$1,575/\$1,495
	F 2/Fx 25		\$365	\$1,260/\$1,125	\$1,835/\$1,680
	F 3/Fx 35		\$525	\$1,365/\$1,205	\$2,100/\$1,940
	F 4/Fx 45		\$785	\$1,470/\$1,335	\$2,625/\$2,465
	F 5/Fx 55		\$785	\$1,575/\$1,415	\$3,150/\$2,990
Medium	F 6		\$1,050	\$2,625	\$5,250
	F 9		\$1,050	\$3,150	\$6,300
	F 12 / Fx125		\$1,050	\$4,200	\$8,400
Large	Fx 175		\$1,310	\$4,725	\$9,450
	F 19		\$1,310	\$5,250	\$10,500
	Fx 225		\$1,310	\$5,775	\$11,550
	F 22		\$1,310	\$6,300	\$12,600
	Fx 275		\$1,310	\$6,560	\$13,125
	F 27		\$1,310	\$6,825	\$13,650
	Fx 375/F 35		\$1,575	\$7,875	\$15,750
	Fx 475/F 45		\$1,575	\$9,450	\$21,000
	Fx 770/F 70		\$1,575	\$13,250	\$26,250
	F 100		\$1,575	\$18,500	\$36,500
AIR	KB555		\$365	\$1,470	
	KB999		\$525	\$1,890	

- 1) In order to be factory tested, the Breaker must be shipped with all the components necessary to its operation.
- 2) Any order may be upgraded to any higher Tier upon the receipt of the Inspection Report, with no penalty, as if it had been ordered at that higher Tier originally.
- 3) Any additional parts required for proper operation but not listed on the final 'Tier' selected can be purchased at List less 30% with no additional charge for installation.
- 4) Warranty offered on Tier III only when any part not meeting FRD.USA's minimum specifications is purchased and replaced.
- 5) No substitutions of parts permitted, regardless of Tier selected.
- 6) This program may not be substituted for or is associated with FRD.USA's standard Warranty Program.

POLICY: The policy of FRDUSA is one of continual improvement. We reserve the right to change design or materials at any time, without notice or creating any obligation to previous or future customers.

PRICE LIST

711 Lake Street -- Kent, Ohio 44240
 Phone: 330-673-5826 // Toll Free: 800-527-2282
 Fax: 330-677-1616
 www.frdusa.com
 orders@frdusa.com



Boom Mounted Mechanical Thumbs

Effective: January 1, 2019

Model	Description	Price
MT 3X10	Mechanical Thumb, 8" Wide x 28" Long, 108 lbs.	\$1,125.00
MT 8X16 TLB	Mechanical Thumb, 12" Wide x 35" Long, 346 lbs.	\$2,025.00
MT 8X16	Mechanical Thumb, 12" Wide x 40" Long, 371 lbs.	\$2,375.00
MT 16X33HD	Mechanical Thumb, 18" Wide x 48" Long, 710 lbs.	\$3,275.00
MT 33X40	Mechanical Thumb, 18" Wide x 52" Long, 820 lbs.	\$4,500.00
MT 40X55	Mechanical Thumb, 24" Wide x 58" Long, 996 lbs.	\$5,100.00
MT 55X65	Mechanical Thumb, 30" Wide x 62" Long, 1410 lbs.	\$7,550.00
MT 65X80	Mechanical Thumb, 34" Wide x 63" Long, 2452 lbs.	\$7,850.00
MT 80X120	Mechanical Thumb, 36" Wide x 73" Long, 3105 lbs.	\$9,975.00

Standard Mounting Hardware Set Included with thumbs.
 Contact FRD.USA for Pricing on Custom Mounting and any Quick Attach System Compatibility Requirements

POLICY: The policy of FRDUSA is one of continual improvement. We reserve the right to change design or materials at any time, without notice or creating any obligation to previous or future customers.

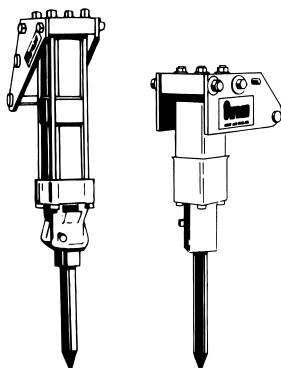

PRICE LIST

711 Lake Street -- Kent, Ohio 44240
Phone: 330-673-5826 // Toll Free: 800-527-2282
Fax: 330-677-1616
www.frdusa.com
orders@frdusa.com

Boom Mounted Pneumatic Hammers

Effective: January 1, 2019

Model	Description	Price \$
B555B	Air Ram (2.50" or 3" Chuck Available), bare, No steel, oiler or side plates "Must specify size of Chuck when ordering"	8,800.00
B555	Air Ram (2.50" or 3" Chuck Available), with working steel, and line oiler "Must specify size of Chuck when ordering"	9,570.00
K07619	Moil Point 2.50"	335.00
K07617	Chisel Bit 2.50"	335.00
K07616	Blunt Tip 2.50"	335.00
K06776	Moil Point 3"	385.00
K06778	Chisel Bit 3"	385.00
K06777	Blunt Tip 3"	385.00
K06821	Moil Point, 36" long 3"	440.00
K07665	Line Oiler 3 Quart Extra Mounting Hardware	950.00 575.00
B999B	Air Ram, 3.50" Chuck, bare, NO steel, oiler, or side plates	16,800.00
B999	Air Ram, 3.50" Chuck, with working steel, and line oiler with standard mounting bracket	19,425.00
B999G	Air Ram, 3.50" Chuck, with working steel, and line oiler, "Gradall" version, with steel plugs	20,460.00
B999H	Air Ram, 3.50" Chuck, with working steel, and line oiler, w/heavy duty side plates	upon request
K02537	Moil Point 3.50" x 30" standard length	440.00
K02543	Chisel Bit 3.50" x 30" standard length	440.00
K02536	Blunt Tip 3.50" x 30" standard length	440.00
K07146	Moil Point 3.50" x 36" long	515.00
K07383	Chisel Bit 3.50" x 36" long	515.00
K07421	Blunt Tip 3.50" x 36" long	515.00
K02545	Moil Point 3.50" x 48" long	620.00
K07145	Chisel Bit 3.50" x 48" long	620.00
K02547	Narrow Chisel Bit, inline blade, 3.50" x 30" long	440.00
K02286	Line Oiler 2 Gallon Extra Mounting Hardware	1350.00 575.00

POLICY: The policy of FRDUSA is one of continual improvement. We reserve the right to change design or materials at any time, without notice or creating any obligation to previous or future customers.